

A

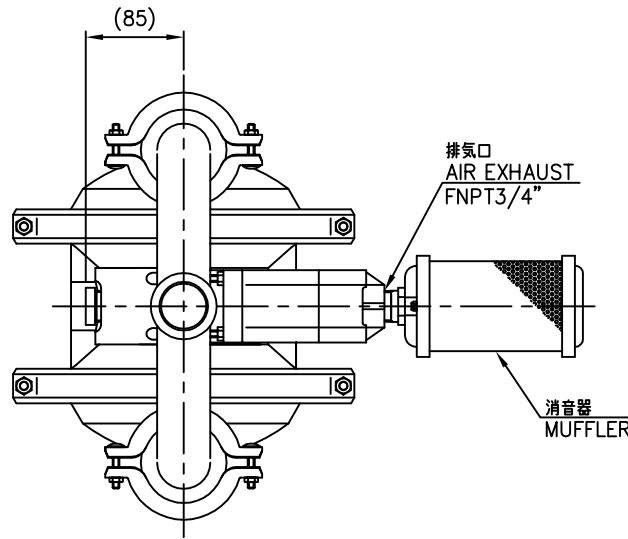

消音器
MUFFLER

MODEL P4 METAL PUMP ALUMINUM

仕様 / Specifications

- 全高 / HEIGHT ----- 429 mm
- 全幅 / WIDTH ----- 368 mm
- 奥行き / DEPTH ----- 491 mm
- 重量 / SHIP WEIGHT ----- 14 kg
- 圧縮空気入口 / AIR INLET --- FNPT1/2"
- 排気口 / AIR EXHAUST ----- FNPT3/4"
- 吸込口 / SUCTION ----- Rc1.1/2"
- 吐出口 / DISCHARGE ----- Rc1.1/4"

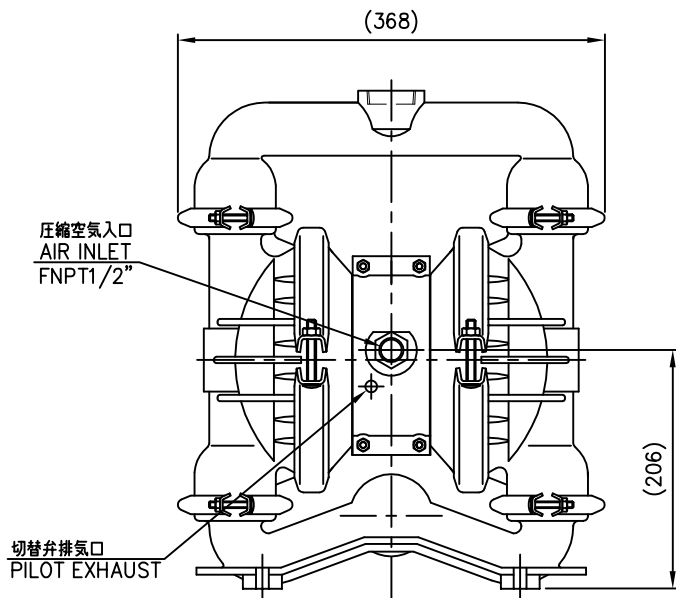

切替弁排気口
PILOT EXHAUST

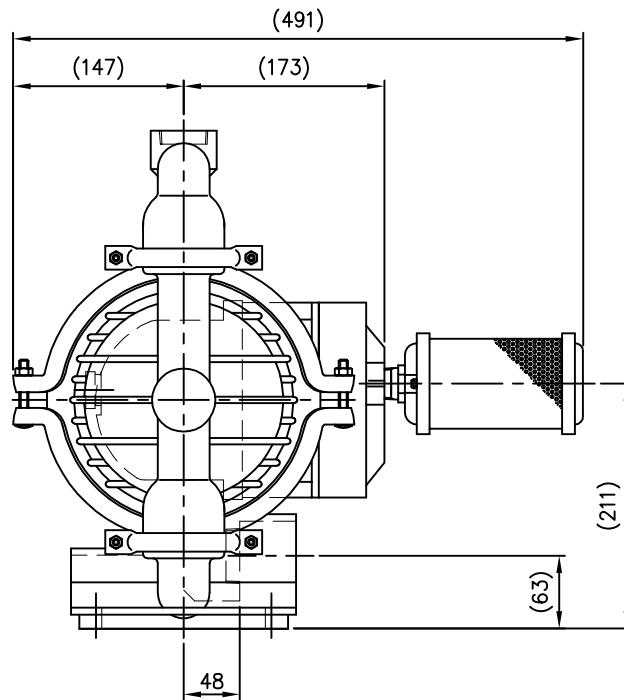

A

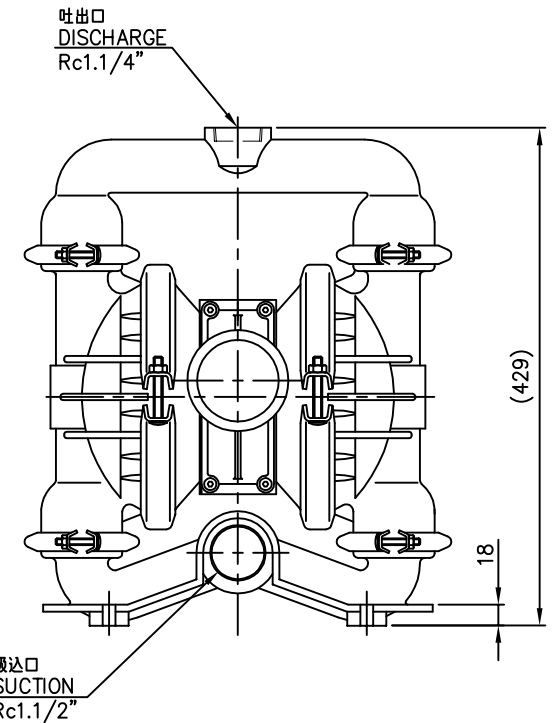

MATERIAL ---	DES. BY		DWG. BY <i>D.Sugiyama</i>	APP. BY	TITLE エアードブルダイヤフラムポンプ WILDEN AIR OPERATED DOUBLE DIAPHRAGM PUMP 型式 / MODEL: P4 ALUMINUM -B
SCALE (A3) 1 : 5			20/05/29		
UNITS	JAPAN MACHINERY COMPANY				
DRAWING NO. P4型 (1.1/4") アルミニウム				REV. MARK 0	